



Instruction Manual



CoComelon™



Grocery Store Track Set



VTech understands that a child's needs and abilities change as they grow and with that in mind we develop our toys to teach and entertain at just the right level...

vtech Baby

Toys that will stimulate their interest in different textures, sounds and colours

I am...

...responding to colours, sounds and textures

...understanding cause and effect

...learning to touch, reach, grasp, sit-up, crawl and toddle

Birth-36 months



Pre-School

Interactive toys to develop their imagination and encourage language development

I want...

...to get ready for school by starting to learn the alphabet and counting

...my learning to be as fun, easy and exciting as can be

...to show my creativity with drawing and music so my whole brain develops

3-6 years



Electronic Learning Computers

Cool, aspirational and inspiring computers for curriculum related learning

I need...

...challenging activities that can keep pace with my growing mind

...intelligent technology that adapts to my level of learning

...National Curriculum based content to support what I'm learning at school

4-10 years



To learn more about this and other VTech® products, visit www.vtech.co.uk

INTRODUCTION

Thank you for purchasing the **CoComelon™ Toot-Toot Drivers® Grocery Store Track Set**.

Roll JJ's race car shopping cart over SmartPoint™ locations on this closed-track system to hear him talk and sing songs from the show. Rush down the ramp and JJ will knock over the display!

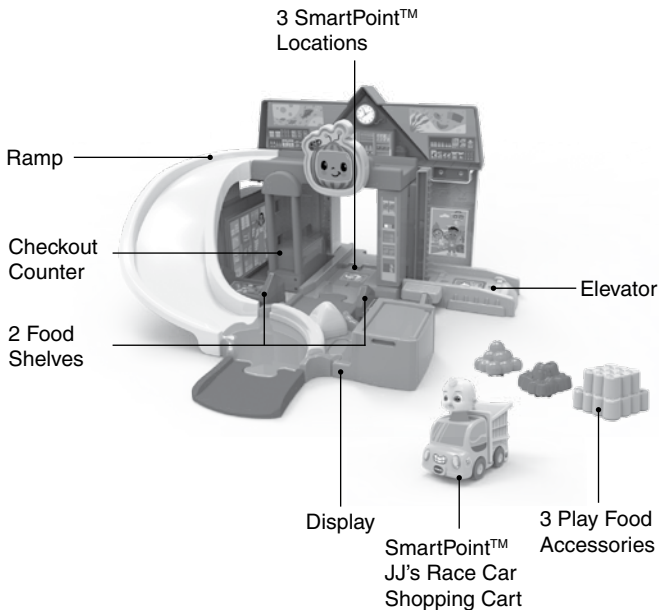

INCLUDED IN THE PACKAGE



One SmartPoint™
JJ's Race Car
Shopping Cart



One store front



One fridge support



One SmartPoint™
base track



One SmartPoint™
second floor track



One ramp



One SmartPoint™
elevator

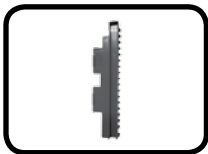

One elevator support



One elevator wall



One sign



One checkout counter



One checkout
counter support



One circle track



One 1/4 track, male



One end track, female



One display



One track guide



Two food shelves

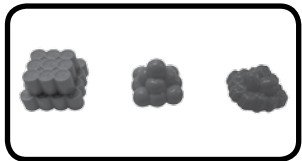

Three play food accessories

- One sticker sheet
- One Quick Start Guide

WARNING:

All packing materials such as tape, plastic sheets, packaging locks, removable tags, cable ties, cords and packaging screws are not part of this toy, and should be discarded for your child's safety.

NOTE:

Please save this manual as it contains important information.

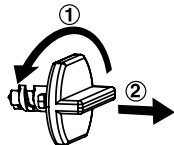
Removing the Packaging Locks:

① Turn the packaging locks anticlockwise several times.

② Pull out the packaging locks and discard.

GETTING STARTED

Battery Removal and Installation

JJ's Race Car Shopping Cart

1. Make sure the unit is turned **Off**.
2. Find the battery cover located on the bottom of the unit, use a screwdriver to loosen the screw and then open the battery cover.
3. Remove old batteries by pulling up on one end of each battery.
4. Install 2 new AAA (AM-4/LR03) batteries following the diagram inside the battery box. (For best performance, alkaline batteries or fully charged Ni-MH rechargeable batteries are recommended).
5. Replace the battery cover and tighten the screw to secure.

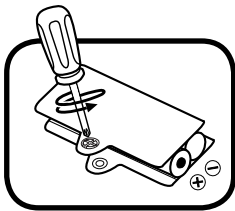
**WARNING:**

Adult assembly required for battery installation.
Keep batteries out of reach of children.

IMPORTANT: BATTERY INFORMATION

- Insert batteries with the correct polarity (+ and -).
- Do not mix old and new batteries.
- Do not mix alkaline, standard (carbon-zinc) or rechargeable batteries.
- Only batteries of the same or equivalent type as recommended are to be used.
- Do not short-circuit the supply terminals.
- Remove batteries during long periods of non-use.
- Remove exhausted batteries from the toy.
- Dispose of batteries safely. Do not dispose of batteries in fire.

RECHARGEABLE BATTERIES:

- Remove rechargeable batteries (if removable) from toy before charging.
- Rechargeable batteries are only to be charged under adult supervision.
- Do not charge non-rechargeable batteries.

Disposal of batteries and product



The crossed-out wheellie bin symbols on products and batteries, or on their respective packaging, indicates they must not be disposed of in domestic waste as they contain substances that can be damaging to the environment and human health.

The chemical symbols Hg, Cd or Pb, where marked, indicate that the battery contains more than the specified value of mercury (Hg), cadmium (Cd) or lead (Pb) set out in the Batteries and Accumulators Regulation.



The solid bar indicates that the product was placed on the market after 13th August, 2005.

 Please dispose of your product and batteries responsibly.

In the UK, give this toy a second life by disposing of it at a small electricals collection point* so all of its materials can be recycled.

Learn more at:

www.vtech.co.uk/recycle

www.vtech.com.au/sustainability

* Visit www.recyclenow.com to see a list of collection points near you.

LABEL APPLICATION

Please securely place the stickers on the track set as indicated on the following pages below:

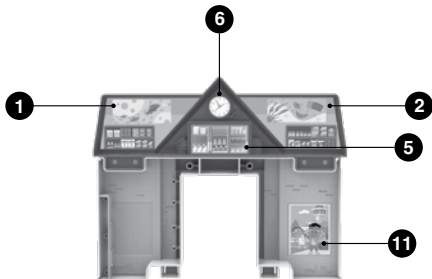
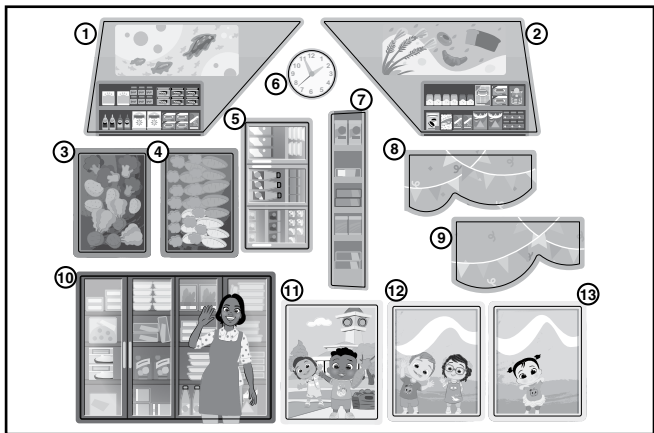

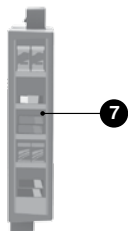
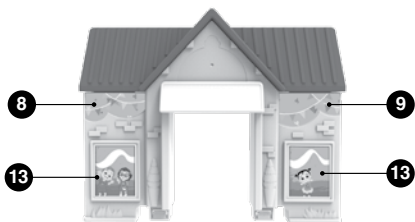

ASSEMBLY INSTRUCTIONS

With the **CoComelon™ Toot-Toot Drivers® Grocery Store Track Set**, safety comes first. Adult assembly is required. For your child's safety, do not let them play with this toy until it is fully assembled.

1. Insert the **Elevator Support** into the **Elevator Wall**. A clicking sound will confirm the pieces are firmly connected. Then slide the **Elevator** into the **Elevator Support** from the bottom.

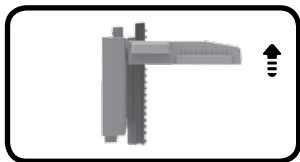
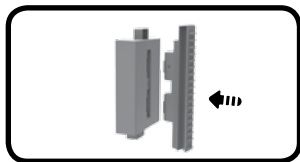

2. Attach the **Second Floor Track** to the **Store Front** from the back, and insert the **Elevator Wall** into the **Base Track**. Connect the **Store Front** to the **Base Track** and the **Second Floor Track** to the **Elevator Wall**.

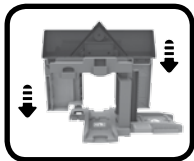
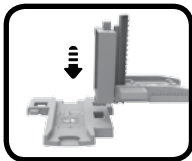

3. Attach the **Checkout Counter** to the **Base Track**, then connect the **Checkout Counter Support** to the **Checkout Counter** and the **Second Floor Track**, Insert the **Sign** into the **Second Floor Track**.

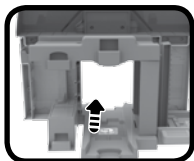

4. Attach the **Fridge Support** to the **Store Front** from the back, then connect the **Ramp** to the **Second Floor Track** and the **Fridge Support**.

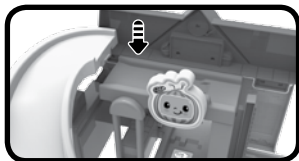
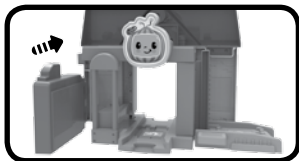

5. Attach the **Circle Track** to the **Ramp**. Then connect it with the **1/4 track (male)**, the **End Track (female)** and the **Display**, Insert the **Track Guide** to the **Circle Track**.

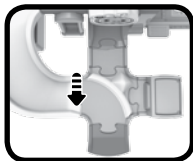
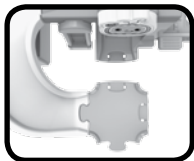

6. Place the accessories as desired, then the **CoComelon™ Toot-Toot Drivers® Grocery Store Track Set** is ready to play!



PRODUCT FEATURES

JJ's Race Car Shopping Cart

1. On/Off Switch

To turn the unit **On**, slide the **On/Off Switch** to the **On** (⏻) position. To turn the unit **Off**, slide the **On/Off Switch** to the **Off** (●) position.

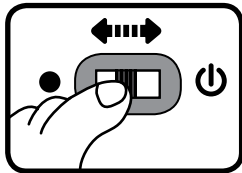

2. Automatic Shut-Off

To preserve battery life, the **JJ's Race Car Shopping Cart** will automatically power down after approximately 60 seconds without input. The unit can be turned on again by pressing the character button, pushing it quickly, or triggering a **SmartPoint™** location.

Note: This **JJ's Race Car Shopping Cart** is in Try-Me mode in the packaging. After opening the package, turn the vehicle off and on again to proceed with normal play. If the unit repeatedly powers down while playing, please install a new set of batteries.

ACTIVITIES

JJ's Race Car Shopping Cart

1. JJ Character Button

Press the **character** to hear sounds, songs, phrases and melodies. The light will flash with the sounds.

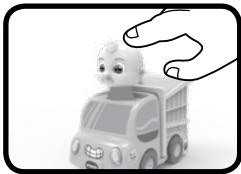

2. SmartPoint™ Locations

For added fun, the **JJ's Race Car Shopping Cart** interacts with the **CoComelon™ Toot-Toot Drivers® Grocery Store Track Set**. Simply put the vehicle on one of the set's three **SmartPoint™** locations to see the cart's lights flash and hear fun phrases, sounds or music. The vehicle even interacts with the other **Toot-Toot Drivers®** track sets (each sold separately).



Grocery Store Track Set

1. SmartPoint™ Elevator

Put the **JJ's Race Car Shopping Cart** on the **SmartPoint™ Elevator**. Raise the **Elevator** to bring the vehicle up to the second floor.

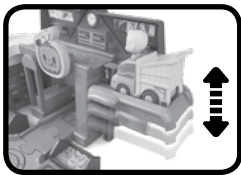

2. Switch Directions

Spin the **Track Guide** to switch the direction the vehicle exits the ramp or remove it to allow the vehicle to go straight.



3. Ramp and Display Launcher

Slide **JJ's Race Car Shopping Cart** down the **Ramp**. Remove the **Track Guide** and place one of the three play food accessories on the **Display**. Push the vehicle down the **Ramp** to see it knock the **Display** and launch the play food accessory off the shelf.



MELODY LIST

1. Freeze Dance
2. Animal Dance
3. Bingo
4. This Is the Way
5. Yes, Yes Bedtime
6. I Want to Be Like Mummy

SONG LYRICS

Song 1

Getting' groceries, Yeah!
At the grocery store.
Getting' groceries, Yeah!
Gonna get some more, oh!

Song 2

Shop, shop, baby
Shop, shop, shop, baby
Shop, shooby, shop some more.
Push that cart 'round the grocery store!

Song 3

When you see something you want,
What's the magic word
Hmmm...Please, please, please.

Song 4

No time to stop, pick up the pace,
Petal to the metal, we're in the race.

Song 5

Green means go! Nice to meet you.
Put it in the cart.
Red means stop!
Time to restart.

CARE & MAINTENANCE

1. Keep the unit clean by wiping it with a slightly damp cloth.
2. Keep the unit out of direct sunlight and away from any direct heat sources.
3. Remove the batteries if the unit will not be in use for an extended period of time.
4. Do not drop the unit on hard surfaces and do not expose the unit to moisture or water.

TROUBLESHOOTING

If for some reason the unit stops working or malfunctions, please follow these steps:

1. Please turn the unit **OFF**.
2. Interrupt the power supply by removing the batteries.
3. Let the unit stand for a few minutes, then replace the batteries.
4. Turn the unit **ON**. The unit should now be ready to play again.
5. If the product still does not work, replace with an entire set of new batteries.

If the problem persists, please contact our Consumer Services Department and a service representative will be happy to help you.

CONSUMER SERVICES

Creating and developing **VTech®** products is accompanied by a responsibility that we at **VTech®** take very seriously. We make every effort to ensure the accuracy of the information, which forms the value of our products. However, errors sometimes can occur. It is important for you to know that we stand behind our products and encourage you to call our Consumer Services Department with any problems and/or suggestions that you might have. A service representative will be happy to help you.

UK Customers:

Phone: 0330 678 0149 (from UK) or +44 330 678 0149 (outside UK)
Website: www.vtech.co.uk/support

Australian Customers:

Phone: 1800 862 155
Website: support.vtech.com.au

NZ Customers:

Phone: 0800 400 785
Website: support.vtech.com.au

PRODUCT WARRANTY/ CONSUMER GUARANTEES

UK Customers:

Read our complete warranty policy online at vtech.co.uk/warranty.

Australian Customers:

VTECH ELECTRONICS (AUSTRALIA) PTY LIMITED –
CONSUMER GUARANTEES

Under the Australian Consumer Law, a number of consumer guarantees apply to goods and services supplied by VTech Electronics (Australia) Pty Limited. Please refer to vtech.com.au/consumerguarantees for further information.

**Visit our website for more
information about our products,
downloads, resources and more.**

www.vtech.co.uk
www.vtech.com.au



CoComelon™ & © 2023 Moonbug Entertainment.
TM & © 2023 VTech Holdings Limited.
All rights reserved.
IM-566100-001
Version:0